

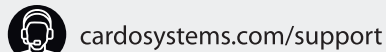

STAY  
IN  
TOUCH

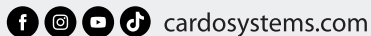

Cardo Connect App



MAN00696\_MAN INSTALLATION GUIDE FOR EDGEPHONES\_A06



PACKTALK  
EDGEPHONES  
INSTALLATION GUIDE

## INSTALLATION VIDEO

Installationsvideo  
Vidéo d'installation  
Video d'installazione  
Video de instalación  
インストール動画  
安装视频

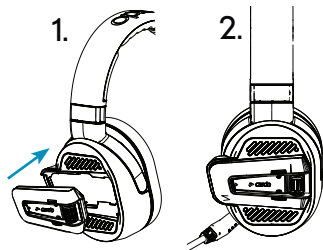

### Push firmly, to make sure the mic is in place

Fest drücken, um sicherzustellen, dass das Mikrofon richtig sitzt  
Appuyez fermement pour vous assurer que le microphone est bien connecté  
Premere con decisione per assicurarsi che il microfono sia in posizione  
Presione firmemente para asegurar que el micrófono está en su sitio  
マイクが接続されるようにしっかり押し込みます  
请用力推入，以确保麦克风妥善到位

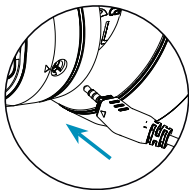

**Arrow Faces Mouth**  
Pfeil zeigt zum Mund  
La flèche doit faire face à la bouche  
La freccia è rivolta verso la bocca  
La flecha va a la boca  
矢印が口に向かうように  
箭头面向嘴部

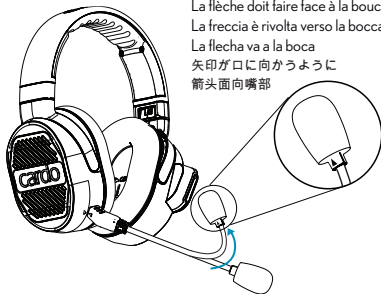

**Adjustable Headbands**  
Verstellbare Stirnbänder  
Arceau réglable  
Bandane regolabili  
Diademas ajustables  
調整可能なヘッドバンド  
可调节头带

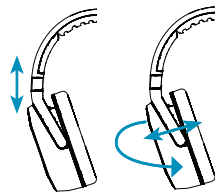

**Removable Paddings**  
Entfernbares Polster  
Imbottiture sfoderabili  
Cousinets amovibles  
Imbottiture sfoderabili  
Almohadillas extraíbles  
取り外し可能なパッド  
可拆卸衬垫

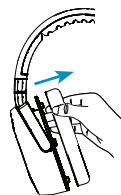

**Compact Folding**  
Kompakt zusammenklappbar  
Pliage compact  
Piegatura compatta  
Plegado compacto  
小型の折り畳み式  
紧凑折叠

